

Machine Assembly

Inspect All Gaskets & Bushings Before Assembly.

MAKE SURE MACHINES IS UNPLUGGED BEFORE ASSEMBLY.

Discard And Replace Any Worn Or Broken Gasket.

Slide Bowl Gasket (3.02) To Back Of The Freezing Cylinder With Flat Side Flush Against Machine Base.

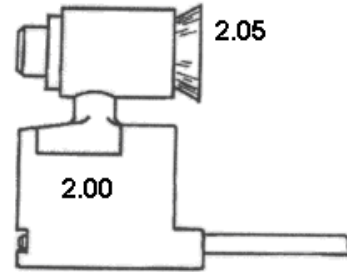
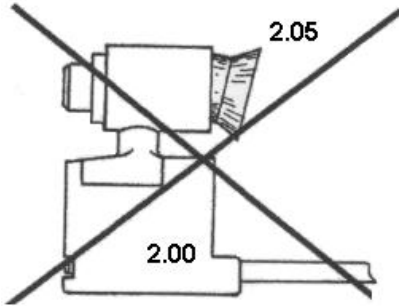

Insert Suction Cap Gasket (2.05) Completely Into Spiral (2.00).

Apply Lube Around Shaft Of Freezing Cylinder.
Slide Spiral (2.00) Back Onto Freezing Cylinder.
Turn Unto Spiral (2.00) Is Locked Into Place.

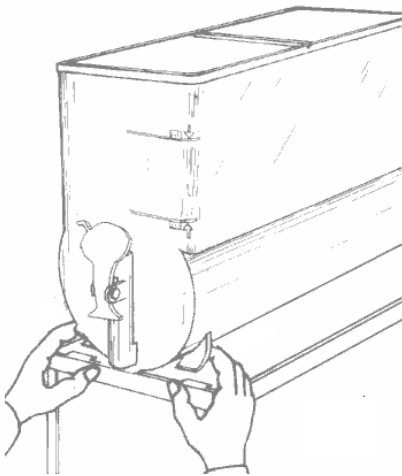
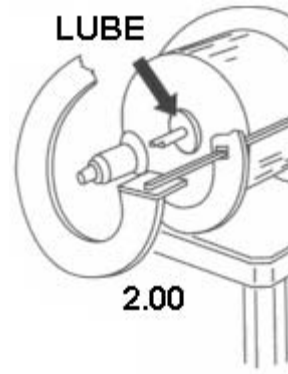

Slide Bowl (5.01) Back Onto Freezing Cylinder.
Gently Snap Bowl Legs Into Place, Will 'Pop'.

Lube White O-Ring (5.08) and Lower Tap Gasket (5.09) on Tap Pin (5.07).

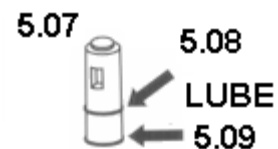

Machine Assembly

Inspect All Gaskets & Bushings Before Assembly.

MAKE SURE MACHINES IS UNPLUGGED BEFORE ASSEMBLY.

Balance Tap Spring (5.06) On Top Of Tap Pin (5.07)
Insert Both Into Bowl Spout Using Finger To Hold In Place.
Insert Handle (5.04) To Lock In Tap Pin (5.07) Continue Holding Handle.
Insert Handle Pin (5.05) To Everything In Place.
Check For Easy Up And Down Motion.

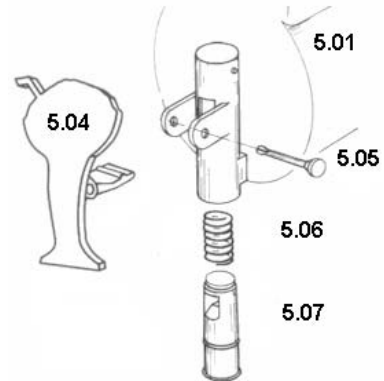

Place Lids On Top Of Bowl (5.01).
Plug In Lid Power Cord (1.05).

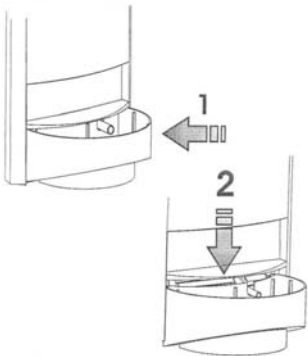

Insert Drip Tray (7.09) In Then Down.
Insert Grate (7.10) Into Drip Tray (7.09).
Plug Machine Power Cord (7.14) Into Wall.

